

W 949.384

LAYOUT OF BOOM SYSTEM

SCALE 1:250

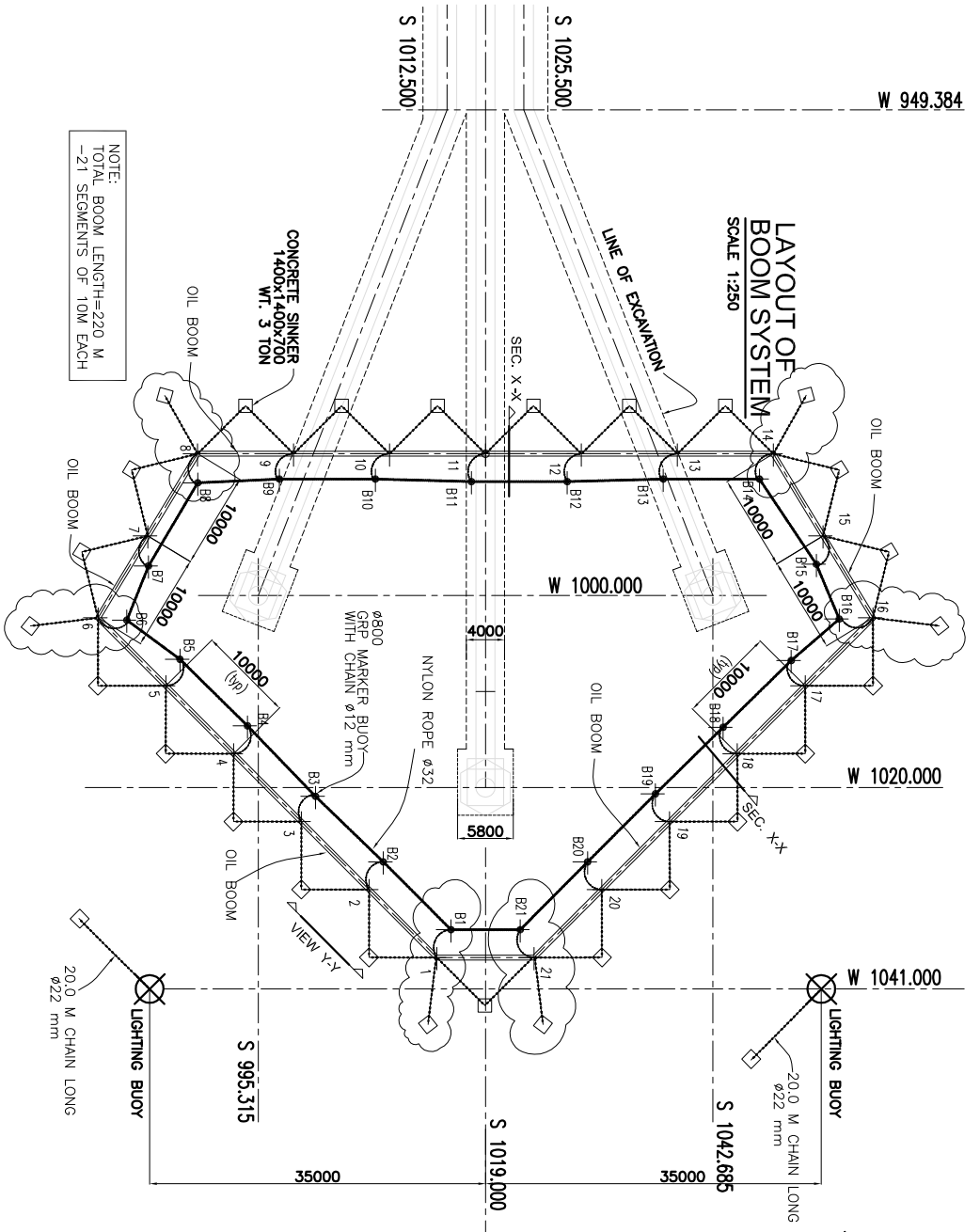

NOTE:
TOTAL BOOM LENGTH=220 M
-21 SEGMENTS OF 10M EACH

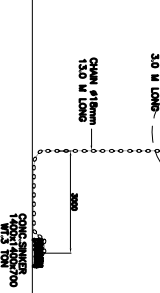
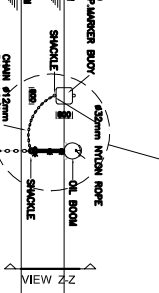
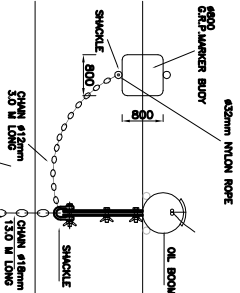
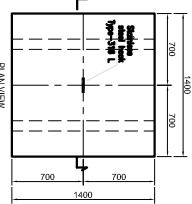
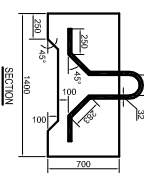
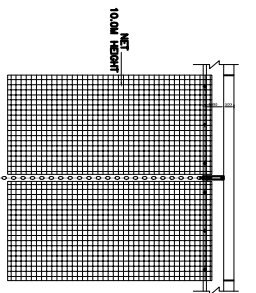

VIEW Y-Y

SCALE 1:125

ARRANGEMENT OF CONNECTION OF BUOYS TO SINKER BLOCKS WITH OIL BOOM

ARRANGEMENT OF CONNECTION OF BUOYS TO SINKER BLOCKS IF OIL BOOM IS REMOVED

SECTION XX

SCALE 1:125

